

TECHNICAL DATA

Assembly	on extension arms with \varnothing 60 x 100 mm ending
Application	residential roads (internal), surrounding office buildings, parks, pedestrians
Ingress protection	IP 66 for the optical part and IP 54 for the driver
Material	anodised aluminium alloy
Unit volume	0,035 m ³
Operating temperature range	from -40°C to +55°C
Expected useful lifetime	L90B10 - 100 000 h
CRI	>70
Inrush current	43 A / 260 μ s
Input voltage frequency	50/60Hz
Power factor	\geq 0.95
Number of LED	12 (36 W), 16 (48 W)
Control system	Luminaire has the possibility to connect to an external control system via DALI interface (optionally via analog signal 1- 10V).



TABLE OF VARIANTS

Code	Symbol	LED power	Luminaire power consumption	LED forward current	Colour temperature (CCT)	LEDs luminous flux ¹	Luminaire luminous flux ¹	Luminous efficacy ¹	Net weight
214332/1	GEMINI LED 36	36 W	42 W	1000 mA	2700 K	5550 lm	5250 lm	131 lm/W	8 kg
214332/3	GEMINI LED 36	36 W	42 W	1000 mA	3500 K	5900 lm	5600 lm	140 lm/W	8 kg
214332/4	GEMINI LED 36	36 W	42 W	1000 mA	4000 K	6250 lm	5950 lm	149 lm/W	8 kg
214332/6	GEMINI LED 36	36 W	42 W	1000 mA	5000 K	6250 lm	5950 lm	149 lm/W	8 kg
214333/1	GEMINI LED 48	48 W	55 W	1000 mA	2700 K	7250 lm	6900 lm	125 lm/W	8 kg
214333/3	GEMINI LED 48	48 W	55 W	1000 mA	3500 K	7700 lm	7300 lm	133 lm/W	8 kg
214333/4	GEMINI LED 48	48 W	55 W	1000 mA	4000 K	8150 lm	7750 lm	141 lm/W	8 kg
214333/6	GEMINI LED 48	48 W	55 W	1000 mA	5000 K	8150 lm	7750 lm	141 lm/W	8 kg

1) tolerance +/- 5% due to LEDs accuracy

2) symbol of chosen optical system eg. 214332/4 is GEMINI LED 36, 4000 K

DIRECTIVES AND STANDARDS

DIRECTIVES: 2014/35/UE (Official Journal of the UE L 96/357 29.03.2014), 2014/30/UE (Official Journal of the UE L 96/79 29.03.2014), 2011/65/UE RoHS (Official Journal of the UE L 174/88 01.07.2011), 2009/125/EC(Official Journal of the UE L 285/10 31.10.2009)

STANDARDS: PN-EN IEC 60598-1: 2021-7, PN-EN 60598-2-3: 2006, PN-EN 60529: 2003, PN-EN 62262: 2003, PN-EN 62471:2010, PN-EN 55015: 2019, PN-EN 61547: 2009, PN-EN 61000-3-2: 2019, PN-EN 61000-3-3: 2014

Lighting parameters presented based on laboratory tests according to IESNA LM-79-19

REMOVING ELECTROSTATIC CHARGE FROM LED LUMINAIRE BODY

In order to efficient discharge the electrostatic charge from the housing of LED fitting installed on the pole from dielectric material (non-conductive) one of the following solutions is required:

- functional grounding
- LED luminaire with an additional protection device

TECHNICAL DRAWING

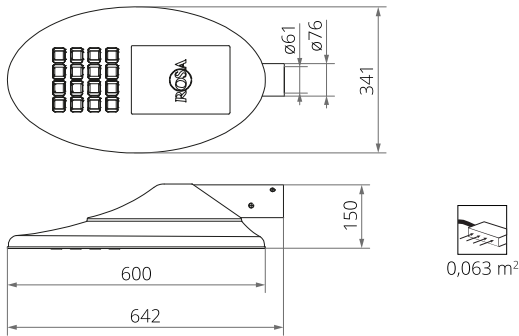

PHOTOMETRIC CURVES

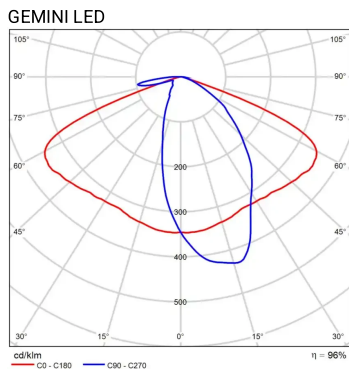

POWER SYSTEM FUNCTIONS

Luminaire in standard has following functions of intelligent power supply:

- Connection to outside control system by DALI interface (operation of analog signal 1-10V as an option),
- Possibility of programming multistage dimming of luminaire, up to 5 intervals in the range of from 10 to 100% of nominal power,
- LED module equipped with thermal protection implemented via an NTC thermistor,
- Regulation of power / luminous flux – the option of setting another value than the catalogue in the range of 30-100% of nominal one,

ACCEPTABLE QUANTITY OF LUMINAIRES ON ONE CIRCUIT

Overcurrent switches MCB type B or C

Luminaire	Typ	2 A	4 A	6 A	10 A	16 A	20 A	25 A
GEMINI LED	B	1	2	4	6	10	12	15
	C	1	4	6	10	17	20	26

Fuse – type gG and GL

Luminaire	2 A	4 A	6 A	10 A	16 A	20 A	25 A
GEMINI LED	0	4	8	11	22	31	44